

**REPORT ON APPLICATION FROM THE
WENDOVER MEMORIAL HALL UNDER THE
LICENSING ACT 2003 FOR A MAJOR
VARIATION OF A PREMISES LICENCE**

1. THE APPLICATION

Applicant(s): Committee of Wendover Memorial Hall

Premises: Wendover Memorial Hall, Wharf Road, Wendover, Aylesbury,
Buckinghamshire, HP22 6HF

1.1 Variation application

The application is for the variation of the Premises Licence under section 34 of the Act. The detail in respect to the hours and activities applied for are set out in the application form, section A to O. Attached as Appendix 1 is a copy of the completed application form, a location plan of the premises is attached as Appendix 5 and a plan of the premises will be made available at the Sub-Committee hearing.

The steps the applicant intends to take to promote the licensing objectives are set out in the operating schedule (see appendix 1).

In an effort to clarify the current and proposed permissions these are set out in Appendix 2.

2. RELEVANT REPRESENTATIONS

2.1 Responsible Authorities

Thames Valley Police – No representation

Environmental Health – No representation

Bucks Fire and Rescue – No representation

Planning – No representation

Trading Standards – No comment

Area Child Protection Committee – No comment

2.2 Interested Parties

During the consultation period 1 representation was received from an interested party. This is attached as appendix 3.

3. NOTICE OF HEARING AND RESPONSES

All parties were served Notices of Hearing on receipt of the representation along with the document, 'Licensing Act 2003 – The Procedure to be followed at Hearings'. The parties have therefore been notified of the consequences of failing to attend.

The further submissions that have been received to date following service of the Notice of Hearing are attached as Appendix 4. Members will be notified of any further responses at the hearing.

4. GENERAL INFORMATION

The general information Members need to have regard to when determining applications made under the Licensing Act 2003 is set out in a separate document which is attached to the Agenda under cover of which this report has been published.

5 ISSUES RAISED BY THE APPLICATION

The issues raised by the application are for the Sub-Committee to determine having regard to all the relevant considerations. Whatever, the Sub-Committee decides, it must give reasons.

To assist Members and the parties further, The Licensing Services Manager will draw attention to any issues arising from this application at the hearing.

Contact Officer
Background Documents

Peter Seal 01296 585083
Names of Background documents

ps-lsc-hst-Wendover Memorial Hall – greens may 2003
licgambact05122007

APPENDIX 1
 EHQ £190
 Banked 8/10/07

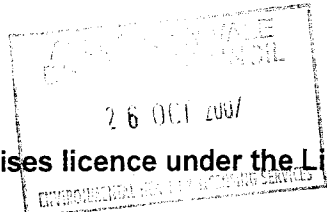

Aylesbury Vale District Council

Form LA06 (11/05)

Application to vary a premises licence under the Licensing Act 2003

PLEASE READ THE FOLLOWING INSTRUCTIONS FIRST

Before completing this form please read the guidance notes at the end of the form.
 If you are completing this form by hand please write legibly in block capitals. In all cases ensure that your answers are inside the boxes and written in black ink. Use additional sheets if necessary.
 You may wish to keep a copy of the completed form for your records.

We COMMITTEE OF THE WENDOVER MEMORIAL HALL
 (Insert name(s) of applicant)

being the premises licence holder, apply to vary a premises licence under section 34 of the Licensing Act 2003 for the premises described in Part 1 below

Premises licence number	PRC404
-------------------------	--------

Part 1 – Premises Details

Postal address of premises or, if none, ordnance survey map reference or description			
WENDOVER MEMORIAL HALL WHARF ROAD WENDOVER			
Post town	AYLESBURY	Post code	HP22 6HF

Telephone number at premises (if any)	01296 622080
Non-domestic rateable value of premises	£ 7,300.00

Part 2 – Applicant details

Daytime contact telephone number	01296 620770 07804 671445		
E-mail address (optional)	ANGIEWMH@AOL.COM		
Current postal address if different from premises address	84 TRING ROAD WENDOVER BUCKS		
Post Town	AYLESBURY	Postcode	HP22 6ND

Part 3 - Variation

Please tick yes

Do you want the proposed variation to have effect as soon as possible?

If not do you want the variation to take effect from

Day	Month	Year

Please describe briefly the nature of the proposed variation (Please see guidance note 1)

TO EXTEND LICENSABLE ACTIVITY TO
INCLUDE SALE OF ALCOHOL.

TO INCLUDE SUNDAY OPENING &
LICENSABLE ACTIVITIES.

TO AMEND OPENING HOURS OF
PREMISES.

If your proposed variation would mean that 5,000 or more people are expected to attend the premises at any one time, please state the number expected to attend

Part 4 Operating Schedule

Please complete those parts of the Operating Schedule below which would be subject to change if this application to vary is successful.

Provision of regulated entertainment

Please tick yes

- | | |
|--|-------------------------------------|
| a) plays (if ticking yes, fill in box A) | <input checked="" type="checkbox"/> |
| b) films (if ticking yes, fill in box B) | <input checked="" type="checkbox"/> |
| c) indoor sporting events (if ticking yes, fill in box C) | <input checked="" type="checkbox"/> |
| d) boxing or wrestling entertainment (if ticking yes, fill in box D) | <input checked="" type="checkbox"/> |
| e) live music (if ticking yes, fill in box E) | <input checked="" type="checkbox"/> |
| f) recorded music (if ticking yes, fill in box F) | <input checked="" type="checkbox"/> |
| g) performances of dance (if ticking yes, fill in box G) | <input checked="" type="checkbox"/> |
| h) anything of a similar description to that falling within (e), (f) or (g)
(if ticking yes, fill in box H) | <input checked="" type="checkbox"/> |

Provision of entertainment facilities:

- | | |
|--|-------------------------------------|
| i) making music (if ticking yes, fill in box I) | <input checked="" type="checkbox"/> |
| j) dancing (if ticking yes, fill in box J) | <input checked="" type="checkbox"/> |
| k) entertainment of a similar description to that falling within (i) or (j)
(if ticking yes, fill in box K) | <input checked="" type="checkbox"/> |

Provision of late night refreshment (if ticking yes, fill in box L)

Sale by retail of alcohol (if ticking yes, fill in box M)

In all cases complete boxes N, O and P

A

Plays Standard days and timings (please read guidance note 6)			<u>Will the performance of a play take place indoors or outdoors or both – please tick</u> (please read guidance note 2)	Indoors	<input checked="" type="checkbox"/>
Day	Start	Finish		Outdoors	<input type="checkbox"/>
Mon	09:00	23:00	<u>Please give further details here</u> (please read guidance note 3) PERFORMANCES BY DRAMA GROUP IE PANTOMIME & PLAYS	Both	<input type="checkbox"/>
Tue	09:00	23:00			
Wed	09:00	23:00	<u>State any seasonal variations for performing plays</u> (please read guidance note 4) CHRISTMAS - PANTOMIME - STANDARD TIMES		
Thur	09:00	23:00			
Fri	09:00	23:00	<u>Non standard timings. Where you intend to use the premises for the performance of plays at different times to those listed in the column on the left, please list</u> (please read guidance note 5)		
Sat	09:00	23:00			
Sun	09:00	22:00			

B

Films Standard days and timings (please read guidance note 6)			<u>Will the exhibition of films take place indoors or outdoors or both – please tick</u> (please read guidance note 2)	Indoors	<input checked="" type="checkbox"/>
Day	Start	Finish		Outdoors	<input type="checkbox"/>
Mon	09:00	23:00	<u>Please give further details here</u> (please read guidance note 3) SHOWING OF FILMS WILL BE SHOWN AT STANDARD TIMINGS USING SOUND SYSTEM INSTALLED IN HALL	Both	<input type="checkbox"/>
Tue	09:00	23:00			
Wed	09:00	23:00	<u>State any seasonal variations for the exhibition of films</u> (please read guidance note 4) NONE		
Thur	09:00	23:00			
Fri	09:00	23:00	<u>Non standard timings. Where you intend to use the premises for the exhibition of films at different times to those listed in the column on the left, please list</u> (please read guidance note 5)		
Sat	09:00	23:00			
Sun	09:00	22:00			

C

Indoor sporting events Standard days and timings (please read guidance note 6)			Please give further details (please read guidance note 3)
Day	Start	Finish	
Mon	09:00	23:00	State any seasonal variations for indoor sporting events (please read guidance note 4)
Tue	''	''	
Wed	''	''	
Thur	''	''	Non standard timings. Where you intend to use the premises for indoor sporting events at different times to those listed in the column on the left, please list (please read guidance note 5)
Fri	''	''	
Sat	''	''	
Sun	09:00	22:30	

D

Boxing or wrestling entertainments Standard days and timings (please read guidance note 6)			Will the boxing or wrestling entertainment take place indoors or outdoors or both – please tick (please read guidance note 2)	Indoors	<input checked="" type="checkbox"/>
Day	Start	Finish		Outdoors	<input type="checkbox"/>
Mon	09:00	23:00	Please give further details here (please read guidance note 3)	Both	<input type="checkbox"/>
Tue	''	''			
Wed	''	''			
Thur	''	''	State any seasonal variations for boxing or wrestling entertainment (please read guidance note 4)		
Fri	''	''			
Sat	''	''			
Sun	09:00	22:30			
			Non standard timings. Where you intend to use the premises for boxing or wrestling entertainment at different times to those listed in the column on the left, please list (please read guidance note 5)		

E

Live music Standard days and timings (please read guidance note 6)			Will the performance of live music take place indoors or outdoors or both – please tick (please read guidance note 2)	Indoors	<input checked="" type="checkbox"/>
				Outdoors	<input type="checkbox"/>
				Both	<input type="checkbox"/>
Day	Start	Finish	Please give further details here (please read guidance note 3)		
Mon	09:00	23:00			
Tue	"	"	State any seasonal variations for the performance of live music (please read guidance note 4)		
Wed	"	"			
Thur	"	"	Non standard timings. Where you intend to use the premises for the performance of live music at different times to those listed in the column on the left, please list (please read guidance note 5)		
Fri	"	"			
Sat	"	"	New years EVE until 00:45		
Sun	09:00	22:30			

F

Recorded music Standard days and timings (please read guidance note 6)			Will the playing of recorded music take place indoors or outdoors or both – please tick (please read guidance note 2)	Indoors	<input checked="" type="checkbox"/>
				Outdoors	<input type="checkbox"/>
				Both	<input type="checkbox"/>
Day	Start	Finish	Please give further details here (please read guidance note 3)		
Mon	09:00	23:00			
Tue	"	"	State any seasonal variations for the playing of recorded music (please read guidance note 4)		
Wed	"	"			
Thur	"	"	Non standard timings. Where you intend to use the premises for the playing of recorded music at different times to those listed in the column on the left, please list (please read guidance note 5)		
Fri	"	"			
Sat	"	"	New years EVE until 00:45		
Sun	09:00	22:30			

G

Performances of dance Standard days and timings (please read guidance note 6)			Will the performance of dance take place indoors or outdoors or both – please tick (please read guidance note 2)		Indoors <input checked="" type="checkbox"/>
					Outdoors <input type="checkbox"/>
					Both <input type="checkbox"/>
Day	Start	Finish	Please give further details here (please read guidance note 3)		
Mon	09:00	23:00	DANCING BY CLASSES AND GROUPS.		
Tue	"	"			
Wed	"	"	State any seasonal variations for the performance of dance (please read guidance note 4)		
Thur	"	"			
Fri	"	"	Non standard timings. Where you intend to use the premises for the performance of dance at different times to those listed in the column on the left, please list (please read guidance note 5)		
Sat	"	"			
Sun	09:00	22:30	New years EVE until 00:45am		

H

Anything of a similar description to that falling within (e), (f) or (g) Standard days and timings (please read guidance note 6)			Please give a description of the type of entertainment you will be providing		
			HIRING HALL OUT TO VARIOUS ENTERTAINERS.		
Day	Start	Finish	Will this entertainment take place indoors or outdoors or both – please tick (please read guidance note 2)		Indoors <input checked="" type="checkbox"/>
Mon	09:00	23:00			Outdoors <input type="checkbox"/>
					Both <input type="checkbox"/>
Tue	"	"	Please give further details here (please read guidance note 3)		
Wed	"	"			
Thur	"	"	State any seasonal variations for entertainment of a similar description to that falling within (e), (f) or (g) (please read guidance note 4)		
Fri	"	"			
Sat	"	"	Non standard timings. Where you intend to use the premises for the entertainment of a similar description to that falling within (e), (f) or (g) at different times to those listed in the column on the left, please list (please read guidance note 5)		
Sun	09:00	22:30	New years EVE until 00:45		

I

Provision of facilities for making music Standard days and timings (please read guidance note 6)			Please give a description of the facilities for making music you will be providing HIRING HALL - NO FACILITIES	
			Will the facilities for making music be indoors or outdoors or both – please tick (please read guidance note 2)	Indoors <input checked="" type="checkbox"/> Outdoors <input type="checkbox"/> Both <input type="checkbox"/>
Day	Start	Finish	Please give further details here (please read guidance note 3)	
Mon	09:00	23:00		
Tue	"	"		
Wed	"	"	State any seasonal variations for the provision of facilities for making music (please read guidance note 4)	
Thur	"	"		
Fri	"	"	Non standard timings. Where you intend to use the premises for provision of facilities for making music at different times to those listed in the column on the left, please list (please read guidance note 5)	
Sat	"	"		
Sun	09:00	22:30	New years eve until 00:45	

J

Provision of facilities for dancing Standard days and timings (please read guidance note 6)			Will the facilities for dancing be indoors or outdoors or both – please tick (see guidance note 2)	
			USE OF HALL	
			Indoors <input checked="" type="checkbox"/> Outdoors <input type="checkbox"/> Both <input type="checkbox"/>	
Day	Start	Finish	Please give a description of the facilities for dancing you will be providing	
Mon	09:00	23:00	Please give further details here (please read guidance note 3)	
Tue	"	"		
Wed	"	"	State any seasonal variations for providing dancing facilities (please read guidance note 4)	
Thur	"	"		
Fri	"	"	Non standard timings. Where you intend to use the premises for the provision of facilities for dancing at different times to those listed in the column on the left, please list (please read guidance note 5)	
Sat	09:00	23:00		
Sun	09:00	22:30	New years eve until 00:45	

K

Provision of facilities for entertainment of a similar description to that falling within i or j Standard days and timings (please read guidance note 6)			Please give a description of the type of entertainment facility you will be providing HIRE OF HALL		
Day	Start	Finish	Will the entertainment facility be indoors or outdoors or both – please tick (please read guidance note 2)	Indoors	<input checked="" type="checkbox"/>
Mon	09:00	23:00		Outdoors	<input type="checkbox"/>
Tue	11	11	Please give further details here (please read guidance note 3)	Both	<input type="checkbox"/>
Wed	11	11			
Thur	11	11			
Fri	11	11	State any seasonal variations for the provision of facilities for entertainment of a similar description to that falling within i or j (please read guidance note 4)		
Sat	11	11	Non standard timings. Where you intend to use the premises for the provision of facilities for entertainment of a similar description to that falling within i or j at different times to those listed in the column on the left, please list (please read guidance note 5)		
Sun	09:00	22:30	NEW YEARS EVE 00:45		

L

Late night refreshment Standard days and timings (please read guidance note 6)			Will the provision of late night refreshment take place indoors or outdoors or both – please tick (please read guidance note 2)			Indoors	<input checked="" type="checkbox"/>
Day	Start	Finish	Please give further details here (please read guidance note 3)	Outdoors	<input type="checkbox"/>		
Mon	09:00	23:00		Both	<input type="checkbox"/>		
Tue	11	11	State any seasonal variations for the provision of late night refreshment (please read guidance note 4)	REQUIRED FOR 24TH DECEMBER AND 31ST DECEMBER			
Wed	11	11					
Thur	11	11					
Fri	11	11	Non standard timings. Where you intend to use the premises for the provision of late night refreshment at different times, to those listed in the column on the left, please list (please read guidance note 5)				
Sat	11	11	NEW YEARS EVE 00:45				
Sun	09:00	22:30	NEW YEARS EVE 00:45				

M

Supply of alcohol Standard days and timings (please read guidance note 6)			Will the supply of alcohol be for consumption (Please tick box) (please read guidance note 7)	On the premises <input checked="" type="checkbox"/>
				Off the premises <input type="checkbox"/>
Day	Start	Finish		Both <input type="checkbox"/>
Mon	14:00 09:00	23:45 23:00	State any seasonal variations for the supply of alcohol (please read guidance note 4) Non-standard timings. Where you intend to use the premises for the supply of alcohol at different times to those listed in the column on the left, please list (please read guidance note 5) New years eve until 00:45	
Tue	14:00 09:00	23:45 23:00		
Wed	14:00 09:00	23:45 23:00		
Thur	14:00 09:00	23:45 23:00		
Fri	14:00 09:00	23:45 23:00		
Sat	14:00 09:00	23:45 23:00		
Sun	14:00 09:00	22:30 22:30		

N

Please highlight any adult entertainment or services, activities, other entertainment or matters ancillary to the use of the premises that may give rise to concern in respect of children (please read guidance note 8) N/A.

O

Hours premises are open to the public Standard days and timings (please read guidance note 6)			State any seasonal variations (please read guidance note 4)	
Day	Start	Finish		
Mon	09:00	23:45	<p>24th DEC AND 31st DEC OPENING LATER DUE TO FESTIVE CELEBRATIONS ...</p>	
	09:00	24:00		
Tue	09:00	23:45		
	09:00	24:00		
Wed	09:00	23:45		
	09:00	24:00		
Thur	09:00	23:45		<p><u>Non standard timings. Where you intend the premises to be open to the public at different times from those listed in the column on the left, please list</u> (please read guidance note 5)</p> <p>new years eve until 00:45</p>
	09:00	24:00		
Fri	09:00	23:45		
	09:00	24:00		
Sat	09:00	23:45		
	09:00	24:00		
Sun	09:00	23:45		
	09:00	23:00		

Please identify those conditions currently imposed on the licence which you believe could be removed as a consequence of the proposed variation you are seeking

NONE KNOWN.

Please tick yes

- I have enclosed the premises licence
- I have enclosed the relevant part of the premises licence
- I have sent copies of this application and the plan to responsible authorities and others where applicable
- I understand that I must now advertise my application
- I understand that if I do not comply with the above requirements my application will be rejected

If you have not ticked one of these boxes please fill in reasons for not including the licence, or part of it, below

Reasons why I have failed to enclose the premises licence or relevant part of premises licence

P Describe any additional steps you intend to take to promote the four licensing objectives as a result of the proposed variation:

a) General – all four licensing objectives (b,c,d,e) (please read guidance note 9)

b) The prevention of crime and disorder

c) Public safety

ENSURE HRS UP TO DATE ON SITE.

d) The prevention of public nuisance

STRICTLY NO 18 x 21 BIRTHDAY PARTIES ALLOWED.
RESTRICT HOURS BY CONTRACT AGREEMENT.

e) The protection of children from harm

Please tick yes

- I have made or enclosed payment of the fee
- I have sent copies of this application and the plan to responsible authorities and others where applicable
- I understand that I must now advertise my application
- I have enclosed the premises licence or relevant part of it or explanation
- I understand that if I do not comply with the above requirements my application will be rejected

IT IS AN OFFENCE, LIABLE ON CONVICTION TO A FINE UP TO LEVEL 5 ON THE STANDARD SCALE, UNDER SECTION 158 OF THE LICENSING ACT 2003 TO MAKE A FALSE STATEMENT IN OR IN CONNECTION WITH THIS APPLICATION

Part 5 – Signatures (please read guidance note 10)

Signature of applicant (the current premises licence holder) or applicant’s solicitor or other duly authorised agent (please read guidance note 11). If signing on behalf of the applicant please state in what capacity.

Signature	<i>J. Williams</i>
Date	<i>15.10.2007</i>
Capacity	<i>SECRETARY TO COMMITTEE OF WENDOVER MEMORIAL HALL</i>

Where the premises licence is jointly held signature of 2nd applicant (the current premises licence holder) or 2nd applicant’s solicitor or other authorised agent (please read guidance note 12). If signing on behalf of the applicant please state in what capacity.

Signature	
Date	
Capacity	

Contact name (where not previously given) and address for correspondence associated with this application (please read guidance note 13) <i>SARAH WILLIAMS (SECRETARY)</i> <i>6 MILL MEAD</i> <i>WENDOVER</i> <i>BOULS</i>			
Post town	<i>HP22 6BT</i>	Post code	
Telephone number (if any)	<i>01296 620770</i>		
If you would prefer us to correspond with you by e-mail your e-mail address (optional) <i>wendovermemorialhall@hotmail.co.uk</i>			

Consent of individual to being specified as premises supervisor

I DIBOW AHMED

[full name of prospective premises supervisor]

of

23 AYLESBURY ROAD
WENBOUR
BOCKS
HP22 6JG.

[home address of prospective premises supervisor]

hereby confirm that I give my consent to be specified as the designated premises supervisor in relation to the application for

VARIATION OF PREMISES LICENCE

[type of application]

by

COMMITTEE OF THE WENBOUR MEMORIAL
HALL

[name of applicant]

relating to a premises licence

PROXY

[number of existing licence, if any]

for

WENBOUR MEMORIAL HALL
WHARF ROAD
WENBOUR
BOCKS
HP22 6HF

[name and address of premises to which the application relates]

and any premises licence to be granted or varied in respect of this application made by

COMMITTEE OF THE WENDOVER MEMORIAL HALL
[name of applicant]

concerning the supply of alcohol at

WENDOVER MEMORIAL HALL
WHARF ROAD
WENDOVER
BUCKS
HP22 6HF
[name and address of premises to which application relates]

I also confirm that I am applying for, intend to apply for or currently hold a personal licence, details of which I set out below.

Personal licence number

51169
[insert personal licence number, if any]

Personal licence issuing authority

Staten Borough Council Luton LU1 2BQ
[insert name and address and telephone number of personal licence issuing authority, if any]

Signed

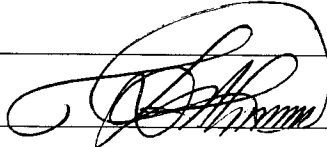

Name (please print)

MR DIBUL AHMED

Date

3 - 10 - 2007

Appendix 2

The application relates to the addition of sale and supply of alcohol and changes to the hours for provision of regulated entertainment

	Supply of Alcohol (on the premises)			
	Existing		Proposed	
	From	To	From	To
Monday	N/A	N/A	09 00	23 00
Tuesday	N/A	N/A	09 00	23 00
Wednesday	N/A	N/A	09 00	23 00
Thursday	N/A	N/A	09 00	23 00
Friday	N/A	N/A	09 00	23 00
Saturday	N/A	N/A	09 00	23 00
Sunday	N/A	N/A	09 00	22 30

	Plays, Films, Boxing or Wrestling, Indoor sporting events, Provision of facilities for making music, Provision of facilities for dancing, Provision of facilities for entertainment similar to music & dancing (Indoor only)			
	Existing		Proposed	
	From	To	From	To
Monday	N/A	N/A	09 00	23 00
Tuesday	N/A	N/A	09 00	23 00
Wednesday	N/A	N/A	09 00	23 00
Thursday	N/A	N/A	09 00	23 00
Friday	N/A	N/A	09 00	23 00
Saturday	N/A	N/A	09 00	23 00
Sunday	N/A	N/A	09 00	22 30

	Live Music, Recorded Music, Performance of Dance, Anything similar to music & dancing			
	Existing		Proposed	
	From	To	From	To
Monday	14 00	02 00	09 00	23 00
Tuesday	14 00	02 00	09 00	23 00
Wednesday	14 00	02 00	09 00	23 00
Thursday	14 00	02 00	09 00	23 00
Friday	14 00	02 00	09 00	23 00
Saturday	14 00	23 45	09 00	23 00
Sunday	N/A	N/A	09 00	22 30

Hours premises open to the public				
	Existing		Proposed	
	From	To	From	To
	Monday	14 00	02 00	09 00
Tuesday	14 00	02 00	09 00	00 00
Wednesday	14 00	02 00	09 00	00 00
Thursday	14 00	02 00	09 00	00 00
Friday	14 00	02 00	09 00	00 00
Saturday	14 00	23 45	09 00	00 00
Sunday	N/A	N/A	09 00	23 30

Non Standard Timings				
New Years Eve until 00.45				

BY EMAIL TO licensing@aylesburyvaldc.gov.uk

Wharf Cottage
45a Wharf Road
Wendover
Aylesbury
Bucks
HP22 6HF

Tel : (01296) 622955

5th November 2007

Dear Licensing Services Manager

We have seen a notice posted outside Wendover Memorial Hall which notifies that the Wendover Memorial Hall management committee have applied for an alcohol license and for an extension to the hours of opening of the hall. We wish to oppose both of these applications. We object, as near neighbours, on the grounds that the hall has functioned perfectly well without it for many years so this represents a change of use. We note that the hall is currently being marketed as a party and wedding reception venue but consider this an inappropriate use due to its close proximity to nearby homes.

As you are well aware, the hall is presently limited to a maximum of 12 occasions per annum when alcohol can be consumed. These occasions often cause nuisance and disturbance, particularly when run in conjunction with music and dancing. We do not want any increase in the number of events with alcohol served. We can see no good reason for extending the opening hours and therefore object to this on the same grounds whilst also pointing out the nuisance and disturbance generally caused by large numbers of people leaving an event at midnight and using the car park at that time.

Yours sincerely,

Mr and Mrs A Hetherington

BY EMAIL TO pseal@aylesburyvaldc.gov.uk and
licensing@aylesburyvaldc.gov.uk

Wharf Cottage
45a Wharf Road
Wendover
Aylesbury
Bucks
HP22 6HF

Tel : (01296) 622955

12th November 2007

Dear Mr Seal

Re: Hearing in respect of Wendover Memorial Hall

Thank you for your letter dated 6th November with enclosures.

Unfortunately, we are unable to attend the hearing scheduled for 5th December as we will both be at work at that time. However, we do not have anything substantially different to say than the points made in our previous communication - which is that we consider it inappropriate to alter the license already in place due to the siting of the hall in a predominantly residential area. Reading through the application it was not clear where "amend opening hours of premises" was being invoked. In the category "prevention of public nuisance" we were pleased to see the prohibition of 18th and 21st birthday parties but do not consider this is sufficient. We consider all private hire occasions for parties and celebrations potentially cause as much nuisance as the parties mentioned - this would include all birthday parties, weddings, anniversaries etc. This is because all such occasions typically have music and dancing and the volume invariably increases during the evening. We feel that with the attraction of an alcohol licence, this nuisance could occur every weekend. This is why we would wish the number of occasions limited to 12.

Yours sincerely,

Mr and Mrs A Hetherington

Wendover Memorial Hall

Wharf Road, Wendover, Buckinghamshire HP22 6HF

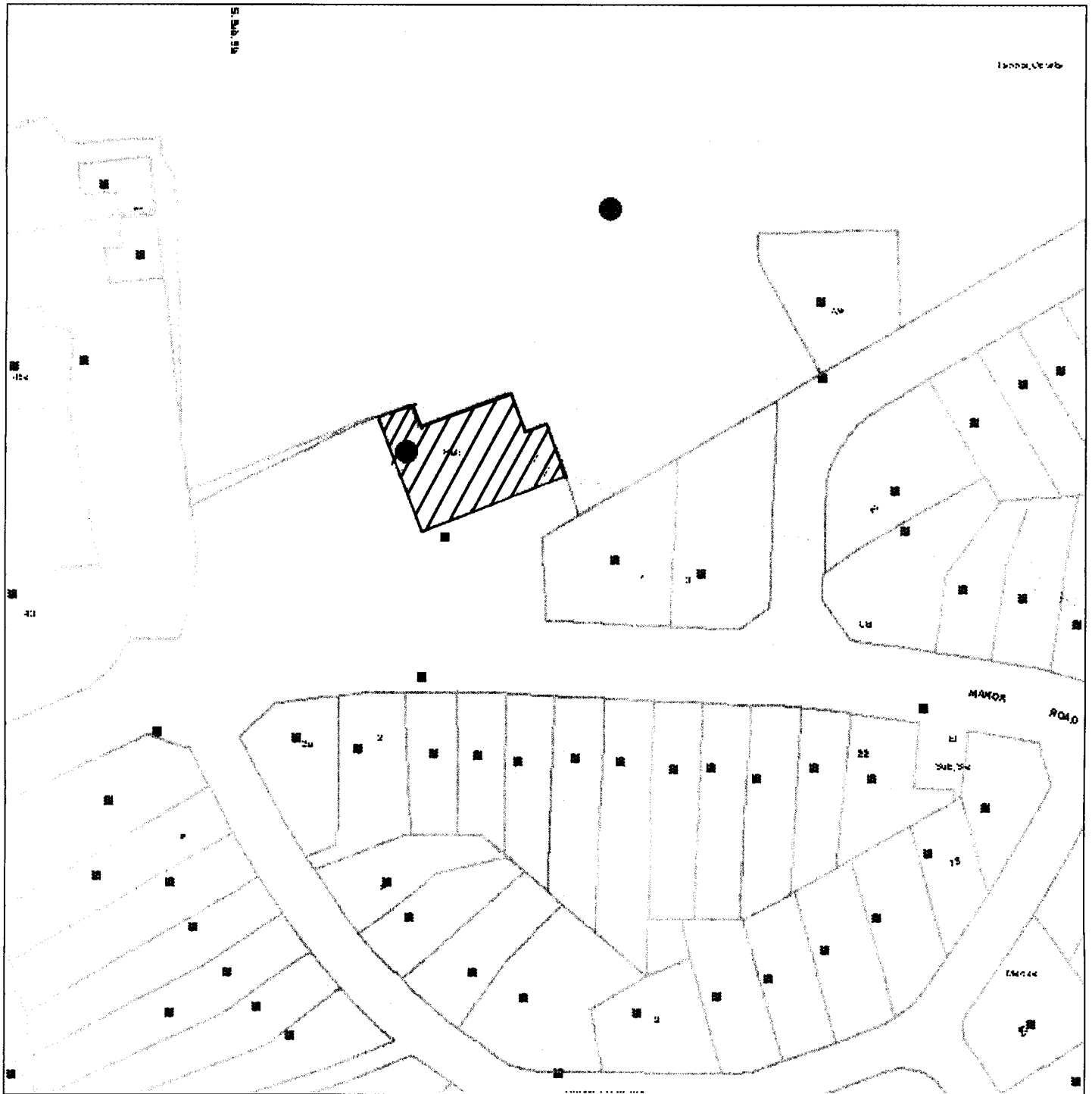

Scale : 1:1000

Reproduced from the Ordnance Survey map with the permission of the Controller of Her Majesty's Stationery Office © Crown Copyright 2000.

Unauthorised reproduction infringes Crown Copyright and may lead to prosecution or civil proceedings.

Organisation	Aylesbury Vale District Council
Department	Licensing
Comments	PR0404 - 07/01498/LAPRE
Date	20 November 2007